

Illustrated Parts & Service Map

HP Compaq dc7900 Ultra Slim Desktop Business PC



© 2008, 2009, 2010 Hewlett-Packard Development Company, L.P. The information contained herein is subject to change without notice. HP shall not be liable for technical or editorial errors or omissions contained herein. Intel, Pentium, Intel Inside, and the Intel logo are trademarks or registered trademarks of the Intel Corporation and its subsidiaries in the U. S. and other countries.

Document Number 506595-003. 3rd Edition June 2010.



Key Specifications

Processor Type	Intel Celeron, Pentium Dual-Core, Core2 Duo, Core2 Quad
RAM Type	DDR2-SODIMMs, PC2 6400 (800 MHz) non-ECC
Maximum RAM Supported	4 GB
Expansion Slots	PCI Express Mini Card
Graphics Adapter	Integrated Intel GMA 3200 graphics
Drive Support	<ul style="list-style-type: none"> 1 hard drive, 2.5-inch 1 Slimline optical 1 mini PCIe solid state drive
I/O Interfaces	USB 2.0 (8), USB 2.0, internal on system board (2), RJ-45 (1), front and rear audio jacks (2 each), PS/2 ports (2), VGA/DVI-D connector

Spare Parts

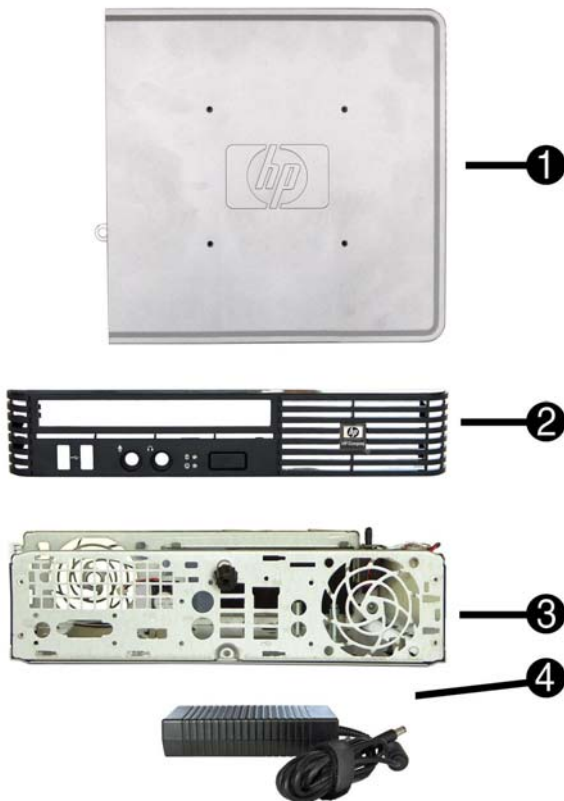

System Unit

1	Access panel	497738-001
2	Front bezel	451388-001
3	Chassis	not spared
4	AC adapter, 135W	482133-001
*	Stand	451396-001
*	Bezel blank	451394-001

* Not shown



Cable and accessory

1	Optical drive cable/connector	499201-001
*	Cable cover	451397-001

* Not shown

Keyboards (not illustrated)

PS/2, Basic	435302-xxx	LA Spanish	-161
USB, Basic	435382-xxx	Norwegian	-091
USB SmartCard	435385-xxx	People's Republic of China	-AA1
Arabic	-171	Portuguese	-131
Belgian	-181	Romanian	-271
BHCSY	-B41	Russian	-251
Brazilian Portuguese	-201	Saudi Arabia*	-DE1
Czech	-221	Slovakian	-231
Danish	-081	South Korea	-KD1
Finnish	-351	Spanish	-071
French	-051	Swedish	-101
French Canadian	-121	Swiss	-111
German	-041	Taiwanese	-AB1
Greek	-151	Thai	-281
Hebrew	-BB1	Turkish	-141
Hungarian	-211	U.S.	-001
International	-B31	U.K.	-031
International English	-L31		
Italian	-061		
Japanese	-291		

*For 435385-xxx only



Mass Storage Devices

1	DVD-ROM drive	494353-001
*	DVD±RW and CD-RW Super Multi Double-Layer Combo Drive with LightScribe	485603-001
*	DVD±RW and CD-RW Combo Drive	485604-001
*	250 GB, 7200 RPM hard drive	497730-001
2	160 GB, 7200 RPM hard drive	497729-001
*	80 GB hard drive	497728-001

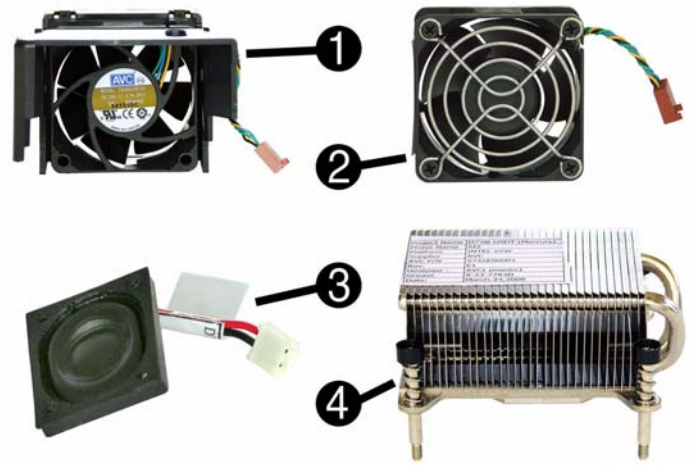
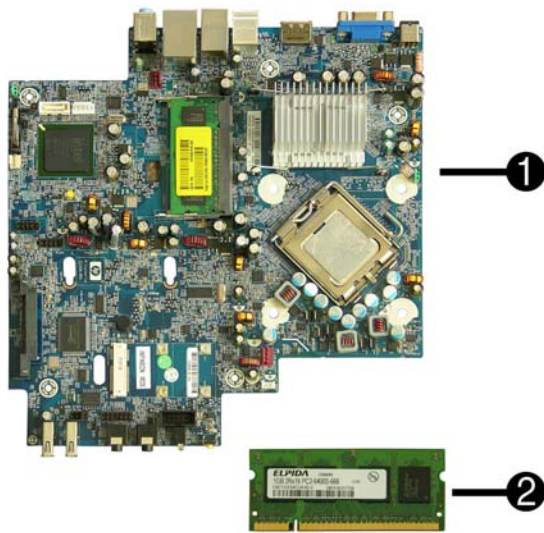

Standard and Optional Boards

System boards with thermal grease, alcohol pad, and CPU socket cover

1	System board	462433-001
*	System board, excludes ES/CS	490631-001

Memory modules (SODIMM, PC2-6400, CL6)

*	4 GB	497739-001
*	2 GB	451400-001
2	1 GB	570027-001
*	512 MB	571246-001

Other boards

*	Quadro NVS295 256-MB PCIe graphics card	519298-001
*	802.11a/b/g/n WLAN module (include card, antenna, cable, and screw)	502482-001

Intel Celeron Processors with alcohol pad and thermal grease

*	450, 2.2 GHz, 512-KB cache, single core	508256-001
*	440, 2.0 GHz, 512-KB cache, single core	449166-001
*	E1500, 2.2 GHz, 512-MB cache, dual core	516899-001
*	E1400, 2.0 GHz, 512-MB cache, dual core	491574-001
*	E1200, 1.6 GHz, 512-MB cache, dual core	468589-001

Intel Pentium Dual Core Processors with alcohol pad and thermal grease

*	E5400, 2.7 GHz, 2-MB L2 cache	531989-001
*	E5200, 2.5 GHz, 2-MB L2 cache	503382-001
*	E2220, 2.4 GHz, 1-MB L2 cache	480714-001
*	E2200, 2.2 GHz, 1-MB L2 cache	465216-001

Intel Core 2 Duo Processors with alcohol pad and thermal grease

*	E8600, 3.33 GHz, 6-MB L2 cache	497732-001
*	E8500, 3.16 GHz, 6-MB L2 cache	466170-001
*	E8400, 3.00 GHz, 6-MB L2 cache	509554-001
*	E8300, 2.83 GHz, 6-MB L2 cache	466168-001
*	E7500, 2.93 GHz, 3-MB L2 cache	531988-001
*	E7400, 2.80 GHz, 3-MB L2 cache	508255-001
*	E7300, 2.66 GHz, 3-MB L2 cache	500134-001
*	E7200, 2.53 GHz, 3-MB L2 cache	490507-001
*	E5300, 2.60 GHz, 2-MB L2 cache	516900-001

* Not shown

Miscellaneous Parts

1	Chassis fan with duct	451392-001
2	Chassis fan, rear	499202-001
3	Internal speaker	447085-001
4	Heatsink with alcohol pad and factory-applied thermal grease	490814-001
*	USB powered speakers	466618-001
*	Mouse, PS2, optical	417966-001
*	Mouse, optical	390938-001
*	Mouse, laser	459821-001
*	Rubber feet, snap in	499204-001
*	Hood sensor	392417-001

*Not shown

System Board

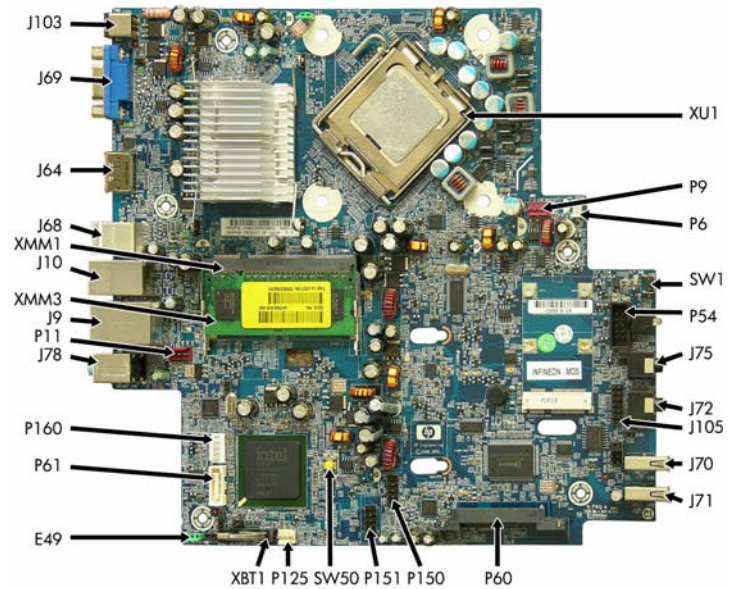

System Board Connectors and Jumpers (position of some untitled components may vary in location)

E49	Password	P11	Auxiliary audio connector
J9	Stacked RJ-45/Dual USB	P54	Primary serial port
J10	Quad stacked USB	P60	First SATA connector
J64	Display port connector	P61	Second SATA connector
J68	Stacked keyboard/mouse connector	P125	Hood sensor
J69	Video connector	P150	Media reader
J70	Primary single USB port	P151	ReadyBoost
J71	Secondary single USB port	P160	SATA power header
J72	Microphone jack	SW1	System front power button
J75	Headphone jack	SW50	Clear CMOS
J78	Double stacked line-out/line-in	XBT1	Real-time-clock battery
J103	DC power input	XMM1	DIMM 1
J105	PCIe Mini Card	XMM3	DIMM 3
P6	Internal speaker	XU1	Processor
P9	Chassis fan		

System Setup and Boot

Basic system information regarding system information, setup, power management, hardware, and passwords is maintained in the Setup Utility held in the system ROM. The Setup Utility is accessed by pressing the F10 key when prompted (on screen) to do so during the boot sequence. If the screen prompt opportunity is missed, a restart will be necessary. For more information about Setup Utilities refer to the *Service Reference Guide*.

Computer Setup Menu

Heading	Option/Description
File	System Information - Lists the following main system specifications: <ul style="list-style-type: none"> Product name SKU number (some models) Processor type/speed/stepping Cache size (L1/L2) Memory size/speed/channels Integrated MAC Address System BIOS Chassis serial number Asset tracking number ME firmware version Management node
	About - Displays copyright notice.
	Set Time and Date - Allows you to set system time and date.
	Flash System ROM - Allows you to select a drive containing a new BIOS.
	Replicated Setup - Save to Rmv Media and Restore from Rmv Media
	Default Setup <ul style="list-style-type: none"> Save Current Settings as Default Restore Factory Settings as Default
	Apply Defaults and Exit - Applies the selected default settings and clears any established passwords.
	Ignore Changes and Exit - Exits Computer setup without saving changes.
	Save Changes and Exit - Saves changes to system configuration or default settings and exits Computer Setup.
	Storage
Storage Options <ul style="list-style-type: none"> Removable Media Boot Legacy Diskette Write SATA Emulation Max eSATA Speed 	
DPS Self-Test - Allows you to execute self-tests on ATA hard drives.	
Boot Order - Allows you to specify boot order. <ul style="list-style-type: none"> Shortcut to Temporarily Override Boot Order 	
Security	Setup Password - Allows you to set and enable the setup (Administrator) password.
	Power-On Password - Allows you to set and enable power-on password.
	Password Options - When any password exists allows you to lock legacy resources, enable/disable network server mode, specify password requirement for warm boot, and allows you to enable/disable Setup Browse Mode.
	Smart Cover (some models) - Allows you to lock/unlock cover lock and set status of cover removal sensor.
	Device Security (some models) - Enables/disables all I/O ports, audio, network controllers, SMBus controller, and embedded security devices.
	USB Security - Allows you to set Device Available/Device Hidden for front USB ports 3-6, rear USB ports 7-12, internal USB ports 1-2.
	Network Service Boot - Enables/disables boot from OS on a server.
	System IDs - Allows you to set Asset tag, ownership tag, Chassis serial number, UUID, and keyboard locale setting.
	DriveLock Security - Allows you to assign/modify a hard drive password for added security.
	System Security (some models) - Allows you to enable/disable: <ul style="list-style-type: none"> Data Execution Prevention Virtualization Technology Virtualization Technology Directed I/O Trusted Execution Technology Embedded Security Device Support OS management of Embedded Security Device through OS Smart Card BIOS Password Support PAVP (Protect Audio Video Path) (some models)
Setup Security Level - Provides method to allow users limited access to change specified setup options without knowing Setup password.	
Power	OS Power Management - Allows you to enable/disable Runtime Power Management, Idle Power Savings, ACPI S3 Hard Disk Reset, ACPI S3 PS2 Mouse Wakeup, USB Wake on Device Insertion (some models), Unique Sleep State Blink Rates.
	Hardware Power Management - Allows you to enable/disable SATA bus power management.
	Thermal - Allows you to control minimum permitted fan idle speed.
Advanced	Power-On Options - Allows you to set: <ul style="list-style-type: none"> POST mode - QuickBoot, FullBoot, or FullBoot every 1-30 days. POST messages - Enable/disable MEBx Setup prompt - Enable/disable or hidden/displayed F9 prompt - Enable/disable F10 prompt - Enable/disable F12 prompt - Enable/disable Factory Recovery Boot Support - Enable/disable Option ROM prompt - Enable/disable WOL After Power Loss - Enable/disable Remote wakeup boot source - Remote server/local hard drive After Power Loss - Off/on/previous state POST delay - None, 5, 10, 15, or 20 seconds Limit CPUID Maximum value to 3
	Execute Memory Test (some models) -Restarts computer and executes POST memory test.
	BIOS Power-On - Allows you to set the computer to turn on at a preset time.
	Onboard Devices - Allows you to set resources or disable onboard system devices.

Computer Setup Menu (Continued)

Heading	Option / Description
	PCI Devices - Lists installed PCI devices with their IRQ settings and allows you to reconfigure IRQ or disable devices.
	PCI VGA Configuration - Allows you to specify which VGA controller will be used when multiple video adapters are available.
	Bus Options (some models) - Allows you to enable/disable PCI SERR# Generation and PCI VGA palette snooping.
	Device Options - Allows you to set: <ul style="list-style-type: none"> Printer Mode - Bi-Directional, EPP & ECP, Output Only Num Lock state at power-on - off/on S5 Wake on LAN - enable/disable Processor cache - enable/disable Integrated video - enable/disable Multi-Processor - enable/disable Internal speaker - enable/disable Monitor Tracking - enable/disable NIC PXE Option ROM Download - enable/disable
	Management Devices - Only displayed in Advanced menu when BIOS detects multiple management options.
	Management Operations - Allows you to set: <ul style="list-style-type: none"> MEBx Setup Prompt - enable/disable Remote Help Prompt - enable/disable Remote Help Lockout - enable/disable Remote Help Connection Timeout - 5, 10, 15, 20, 30, 40, 50, 60, 120, 180, 240 seconds SOL Character Echo - enable/disable SOL Terminal Emulation Mode - enable/disable SOL Keyboard (enable/disable)

System Hardware Interrupts

IRQ	System Function	IRQ	System Function
0	Timer Interrupt	8	Real-Time Clock
1	Keyboard	9	Unused
2	Interrupt Controller Cascade	10	Unused, available for PCI
3	Serial Port (COM B)	11	Unused, available for PCI
4	Serial Port (COM A)	12	Mouse
5	Unused, available for PCI	13	Coprocessor
6	Diskette Drive	14	Primary ATA (IDE) Controller
7	Parallel Port (LPT 1)	15	Secondary ATA (IDE) Controller

Common POST Error Messages

Screen Message	Probable Cause	Recommended Action
101-Option ROM Error	1. System ROM checksum error. 2. Expansion board option ROM checksum	1. Verify ROM, reflash if required 2. Remove suspected card, reboot 3. Clear CMOS memory, reboot 4. Replace system board
103-System Board Failure	DMA, timers	1. Clear CMOS memory. 2. Remove expansion boards. 3. Replace system board.
164-Memory Size Error and 201-Memory Error	Incorrect memory configuration	1. Run Setup (F10). 2. Check DIMMs for proper seating, type, and HP compatibility. 3. Remove DIMMs singularly and reboot to isolate faulty DIMM. 4. Replace system board.
214-DIMM Configuration Warning	Populated DIMM configuration is not optimized	Rearrange the DIMMs so that each channel has the same amount of memory.
301-, 304-Keyboard error	Keyboard failure.	Check keyboard connection or keys. Check connector for bent or missing pins. Replace keyboard. If 304, possible system board problem.
501-Display Adapter Failure	Graphics display controller.	1. Reseat graphics card. 2. Clear CMOS. 3. Check monitor connection. 4. Replace graphics card.
1720-SMART Hard Drive Detects Imminent Failure	Hard drive is about to fail.	1. Determine if hard drive is giving correct error message. Enter Computer Setup and run the Drive Protection System test under Storage > DPS Self-test . 2. Apply hard drive firmware patch if applicable. 3. Back up contents and replace hard drive.
1796-SATA Cabling Error	One or more SATA devices are improperly attached. For optimal performance, the SATA 0 and SATA 1 connectors must be used before SATA 2 and SATA 3.	Ensure SATA connectors are used in ascending order. For one device, use SATA 0. For two devices, use SATA 0 and SATA 1. For three devices, use SATA 0, SATA1, and SATA 2.
1801-Microcode Patch Error	Processor not supported by ROM BIOS.	1. Upgrade BIOS to proper version. 2. Change the processor.

Failsafe Boot Block ROM

The computer comes with a reprogrammable flash system ROM (read only memory). To upgrade the ROM, download the latest ROM BIOS image from the HP Web site (www.hp.com) and follow the online GUI/instructions.

Your system ROM includes a Failsafe Boot Block that is protected during the flash process and allows the computer to be restarted in the unlikely event of an unsuccessful ROM flash. If the system detects an invalid system ROM during the boot sequence, the Failsafe Boot Block attempts to locate a valid BIOS image on removable media. To recover from the Boot Block recovery mode complete the following steps:

Boot Block Recovery

1. Remove any bootable media from the computer and turn off power.
2. Insert a flash drive or CD containing the ROM BIOS in the root directory. The media must be formatted using the FAT12, FAT16, or FAT32 file system.
3. Turn on power to the system.
4. The system will automatically flash the ROM.

NOTE: BitLocker prevents Windows Vista from booting when a CD containing the BIOS image file is in an optical drive. If BitLocker is enabled, remove this CD before attempting to boot to Windows Vista.

Password Security

Establishing a Setup or Power-On password:

1. Turn on or restart the computer. If you are in Windows, click **Start > Shut Down > Restart**.
2. As soon as the computer is turned on, press **F10** when the monitor light turns green to enter Computer Setup. Press **Enter** to bypass the title screen, if necessary. If you do not press **F10** when prompted, a restart will be necessary.
3. To establish a Setup password, select **Security > Setup Password** and follow the instructions on the screen.
 - or -
 - To establish a Power-On password, select **Security > Power-On Password** and follow the instructions on the screen
4. Before exiting, click **File > Save Changes and Exit**.

Changing a Setup or Power-On password:

1. Turn on or restart the computer. If you are in Windows, click **Start > Shut Down > Restart**. To change the Setup password, go to step 2. To change the Power-on password, go to step 3.
2. To change the Setup password, as soon as the computer is turned on, press **F10** when the monitor light turns green to enter Computer Setup. Press **Enter** to bypass the title screen, if necessary.
3. When the key icon appears, type your current password, a slash (/) or alternate delimiter character, your new password, another slash (/) or alternate delimiter character, and your new password again as shown:

current password/new password/new password.

NOTE: Type the new password carefully since the characters do not appear on the screen.

4. Press **Enter**.

The new password will take effect the next time the computer is restarted.

Deleting a Power-On or Setup password

1. Turn on or restart the computer. If you are in Windows, click **Start > Shut Down > Restart**. To delete the Setup password, go to step 2. To delete the Power-On password, go to step 3.
2. To change the Setup password, as soon as the computer is turned on, press **F10** when the monitor light turns green to enter Computer Setup. Press **Enter** to bypass the title screen, if necessary.
3. When the key icon appears, type your current password followed by a slash (/) or alternate delimiter character as shown. Example: `currentpassword/`
4. Press **Enter**.

Security Features

Diagnostic Functions

Diagnostic functions are provided by the Setup Utility (in system ROM) and by HP Insight Diagnostics. HP Insight Diagnostics provides detailed system information including:

- Processor type and speed
- Memory amount, mapping, and integrity
- Hardware peripheral availability/settings
- Hard drive type, space used/available
- System identification, asset tracking

Insight Diagnostics may be found on the *Documentation and Diagnostics* CD that shipped with the computer. The tool may also be downloaded from the HP Web site using the following procedure:

1. Go to www.hp.com
2. Click the **Software & Download driver** link.
3. Enter the product number (for example, dc7900) in the text box and press the **Enter** key.
4. Select the specific product.
5. Select the OS.
6. Click the **Diagnostics** link.
7. Select **HP Insight Diagnostics Offline Edition**.
8. Click **Download**.

NOTE: The download includes instructions on how to create a bootable CD.

Clearing CMOS

1. Turn off the computer and any external devices, and disconnect the power cord from the power outlet.
2. Remove the chassis access panel.
3. On the system board, press and hold the CMOS button for 5 seconds.
4. Replace the chassis access panel and reconnect the power cord.
5. Turn on the computer and allow it to start.

Error Conditions and Messages

Feature	Purpose	How It Is Established
Floppy drive controller	Prevents the transfer of data to or from the floppy drive.	Setup Utilities
Device Boot Disabling	Prevents booting from and or all of these devices: Internal or external USB, Internal ODD, or Internal FDD	Setup Utilities
Security Option	Prevents use of computer until password is entered. Can apply to both initial startup and restart.	Setup Utilities
BIOS Write Protect	Restricts ability to change ROM BIOS without approval.	Setup Utilities.
USB Controller	Allows you to disable or enable all USB devices.	Setup Utilities

Diagnostic LEDs

LED	Color	LED Activity	State/Message
Power	Green	On	Computer on
Power	Green	1 blink every 2 seconds	Normal Suspend Mode
Power	Red	1 blink every second followed by a 2 second pause	CPU thermal shutdown
Power	Red	3 blinks, 1 blink every second followed by a 2 second pause	Processor not installed
Power	Red	4 blinks, 1 blink every second followed by a 2 second pause	Power failure (power supply overload)
Power	Red	5 blinks, 1 blink every second followed by a 2 second pause	Pre-video memory error
Power	Red	6 blinks, 1 blink every second followed by a 2 second pause	Pre-video graphics error
Power	Red	7 blinks, 1 blink every second followed by a 2 second pause	System board failure (ROM)
Power	Red	8 blinks, 1 blink every second followed by a 2 second pause	Invalid ROM based on Checksum
Power	Red	9 blinks, 1 blink every second followed by a 2 second pause	System powers on but is unable to boot
Power	Red	10 blinks, 1 blink every second followed by a 2 second pause	Bad option card
Power	Red	11 blinks, 1 blink every second followed by a 2 second pause	The current processor does not support a feature previously enabled on this system.
none	none	System does not power on and LEDs are not flashing	System unable to power on